

LiTec

Pond One[®]

Models: LED20x1 / LED20x3 / LED20x5



Instruction Manual

Important Safeguards

WARNING: To guard against injury, basic safety precautions should be observed, including the following:

This appliance is not intended for use by children or infirm persons. Always supervise any child in the vicinity of this appliance, ponds, dams or reservoirs.

Read and follow all safety instructions before using this appliance. There maybe additional electrical safety instructions relevant to your country on page 3.

Warning: To avoid possible electric shocks, special care should be taken where water and electricity are combined, for each of the following situations do not attempt repairs yourself. Return the appliance to an authorised dealer for servicing.

If you have any doubts about the electrical installation you should consult a qualified electrician. Please observe local laws and regulations regarding the installation of ponds and pond equipment. Always abide by these regulations. If in any doubt please consult your local government planning department or authority.

All products intended for outdoor installation like pond equipment must be installed with a residual earth leakage circuit breaker (**RCCB** or **RCCD** of 30mA in the supply line to the appliance.

If the appliance shows any sign of abnormal water leakage or malfunction, immediately disconnect it from the power source. Do not attempt repairs yourself.

Carefully examine the appliance after installation. It should not be plugged in or connected to the mains power supply when there is water present on parts which are not supposed to be wet.

Do not operate the appliance if it has a damaged power supply cord or plug, or it is malfunctioning, or has been dropped or damaged in any manner.

If the plug or socket does get wet, do not unplug or disconnect the appliance from the socket. Disconnect the fuse or circuit breaker that supplies the power to the appliance, then unplug and examine for presence of water in the socket.

To avoid the possibility of the appliance plug or mains connection socket getting wet, position the switch box or outdoor weather proof socket at least 2 meters from the pond side. It should also be raised above possible flooding zones.

Always disconnect the appliance from the electrical outlet when not in use, before putting on or taking off parts, before any type of maintenance or cleaning. Never yank or use the power cord to pull it from the outlet or from the pond. Only carry by the main appliance body.

Do not use the appliance for reasons other than the intended use. The use of attachments that are not recommended or sold by the appliance manufacturer may cause the product to be unsafe. We strongly recommend against it.

Do not install or store the appliance where it will be exposed to weather or temperatures below freezing.

Read and observe all the important notices on the appliance type plate.

The appliance comes with 1.8 meters of mains power cable to the transformer. If this is to be extended an approved outdoor connector must be used. However faults to your Pond One product due to moisture ingress at such a connection will not be covered by the our guarantee.

The electrical supply cable is sealed into the transformer and can not be replaced. If it becomes damaged at all the transformer is unusable and should not be used again. It should be disposed of in an environmentally safe way.

NEVER CARRY THE LIGHT BY THE ELECTRIC SUPPLY CABLE THIS WILL DAMAGE THE LIGHT AND MAKE IT UNSAFE.

For Guarantee Conditions, please refer to the Guarantee form on page 9 of this instruction manual.

Before First Use / Preparation

Read and follow all the instructions, even if you feel you are familiar with the product and find a place to keep the instructions handy for future reference. Your attention is drawn particularly to the sections concerning “**IMPORTANT SAFEGUARDS**” and the “**GUARANTEE CONDITIONS**”. Please ensure you retain your original purchase receipt in the event that guarantee service is required.

Carefully unpack the Lights making sure you keep all the packing material until all the parts of the product have been found and the product has been assembled.

This product is shipped to you in a factory sealed carton. Should the product malfunction in any way or if the unit is damaged and requires replacement, contact the retailer where the product was purchased for inspection.

Know Your Lights

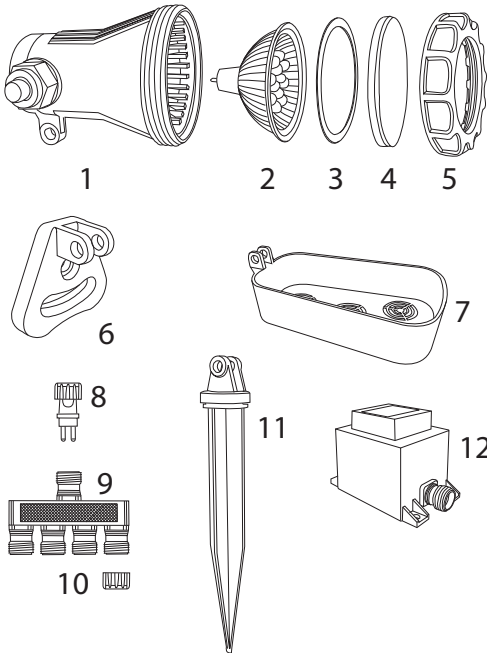

- 1. Light Casing
- 2. Globe
- 3. O-ring
- 4. Glass Lens
- 5. Screw on Cover
- 6. Wall Mounting Bracket
- 7. Weighted Base
- 8. Pin Connection
- 9. Expander Cable Junction
- 10. Cap
- 11. Ground Pick
- 12. Transformer

Replacement Parts & Optional Extras

Use Pond One Genuine Spare Parts Only. See your local Pond One Dealer and look for the number listed below for the spare part you require.

White Replacement Lamp	93210
Red Replacement Lamp	93211
Green Replacement Lamp	93212
Blue Replacement Lamp	93213
EXTx1 Pond Light Extension x1 Light - 5m Cable	93220
5m Extension Cable suit 20 & 50LED Light Set	93225
10m Extension Cable suit 20 & 50LED Light Set	93226
2way Expander Cable Junction suit 20LED Light Set	93227
3way Expander Cable Junction suit 20LED Light Set	93228
4way Expander Cable Junction suit 20LED Light Set	93229

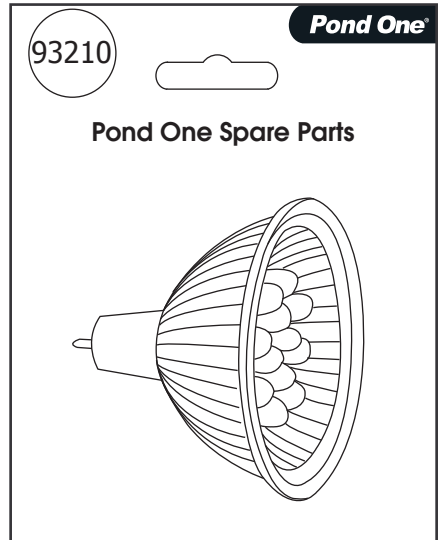

Connecting your appliance to the mains electricity supply

- Country specific instructions.

Always check local government regulations prior to installing your Pond One product

United Kingdom

According to government guidelines pond equipment intended for permanent installation outside must be supplied without a fitted plug.

These appliances are intended for connection to or hard wiring to the mains supply by means other than a conventional plug and socket

This means either a suitable specialist weather proof outdoor socket or a hard wired socket indoors must be used. All cables from the appliance to the socket should be led through a suitable approved conduit and buried in the ground or raised above the ground so clearly visible. Thus avoiding accidental damage from actions like digging of the ground or mowing of the grass.

A approved earth leakage circuit breaker (RCCB) or otherwise known as an Residual circuit current device (RCCD) must be fitted in the supply line.

The appliance should be connected to the mains supply using the following colour coding. Refer to Diagram 1

Red or brown wire - to the live connection 'L'

Blue or black wire - to the Neutral connection 'N'

Green with Yellow stripe wire - to the Earth connection 'E'

IF YOU ARE IN ANY DOUBT ABOUT INSTALLING YOUR APPLIANCE YOU SHOULD CONSULT A QUALIFIED ELECTRICIAN.

Australia, New Zealand and Hong Kong

In Australia, New Zealand and Hong Kong all products are supplied with fitted plugs. This plug should **NOT** be tampered with in any way or removed. Removal or tampering with the plug invalidates our guarantee offered with this product.

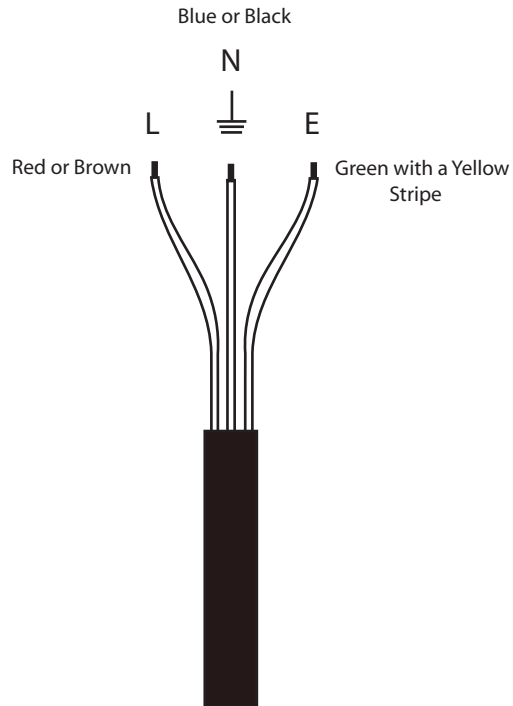
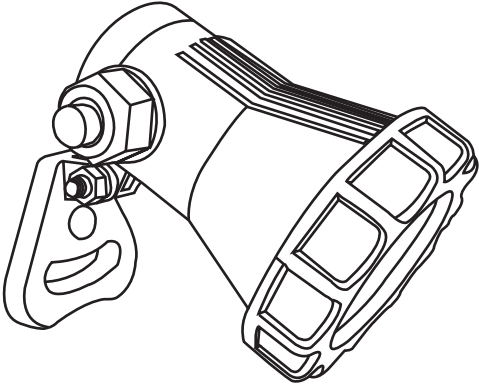
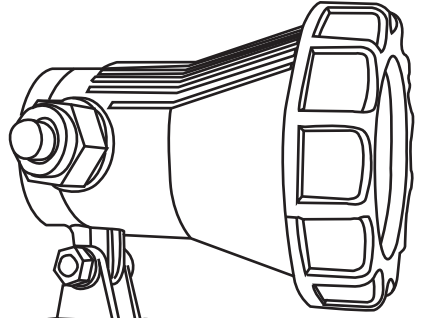

Diagram 1

Setting Up Your Light



1. Wall Mount Option



2. Ground Stake Option

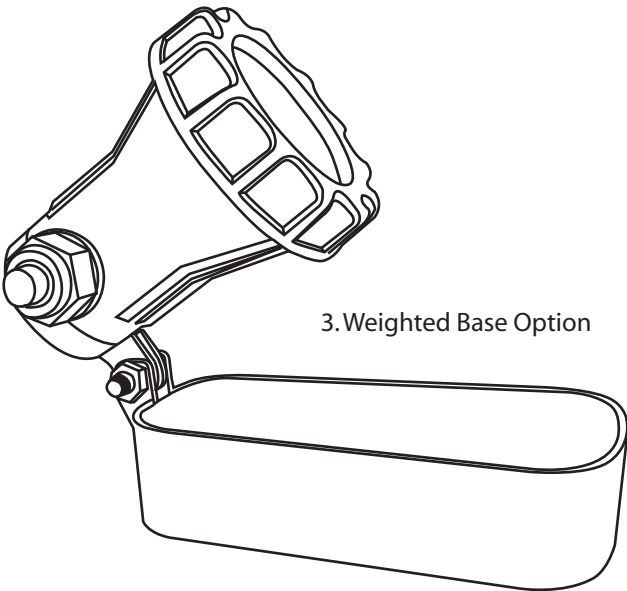

3. Weighted Base Option

LiTech LED20x5 Set Up Option. Round Configuration

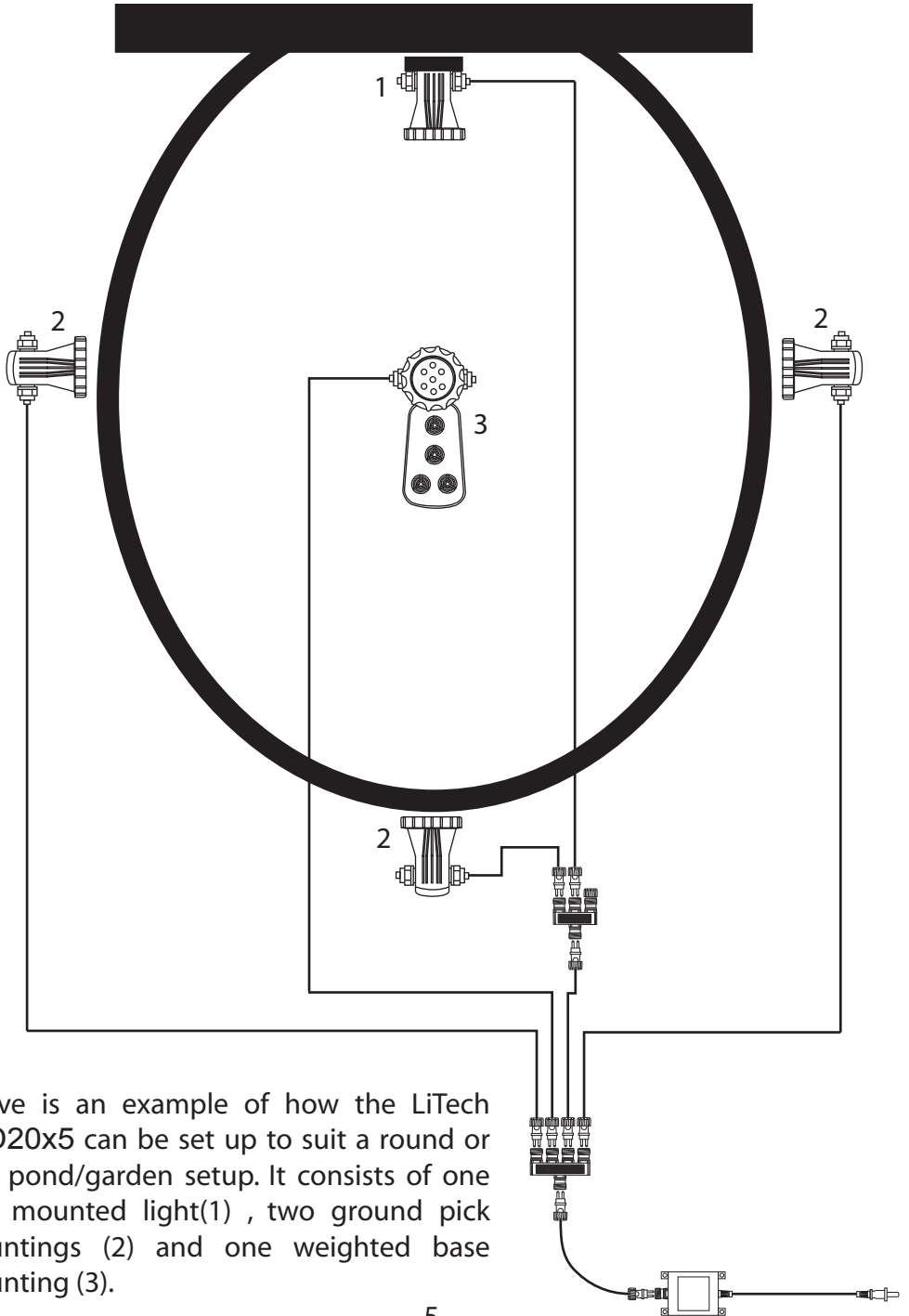

Above is an example of how the LiTech LED20x5 can be set up to suit a round or oval pond/garden setup. It consists of one wall mounted light(1) , two ground pick mountings (2) and one weighted base mounting (3).

LiTech LED20x3 Set Up Option. L Shape Configuration

Below is an example of how the LiTech LED20x3 can be set up to suit an "L" shaped pond/garden setup. It consists of three weighted base mountings (3).

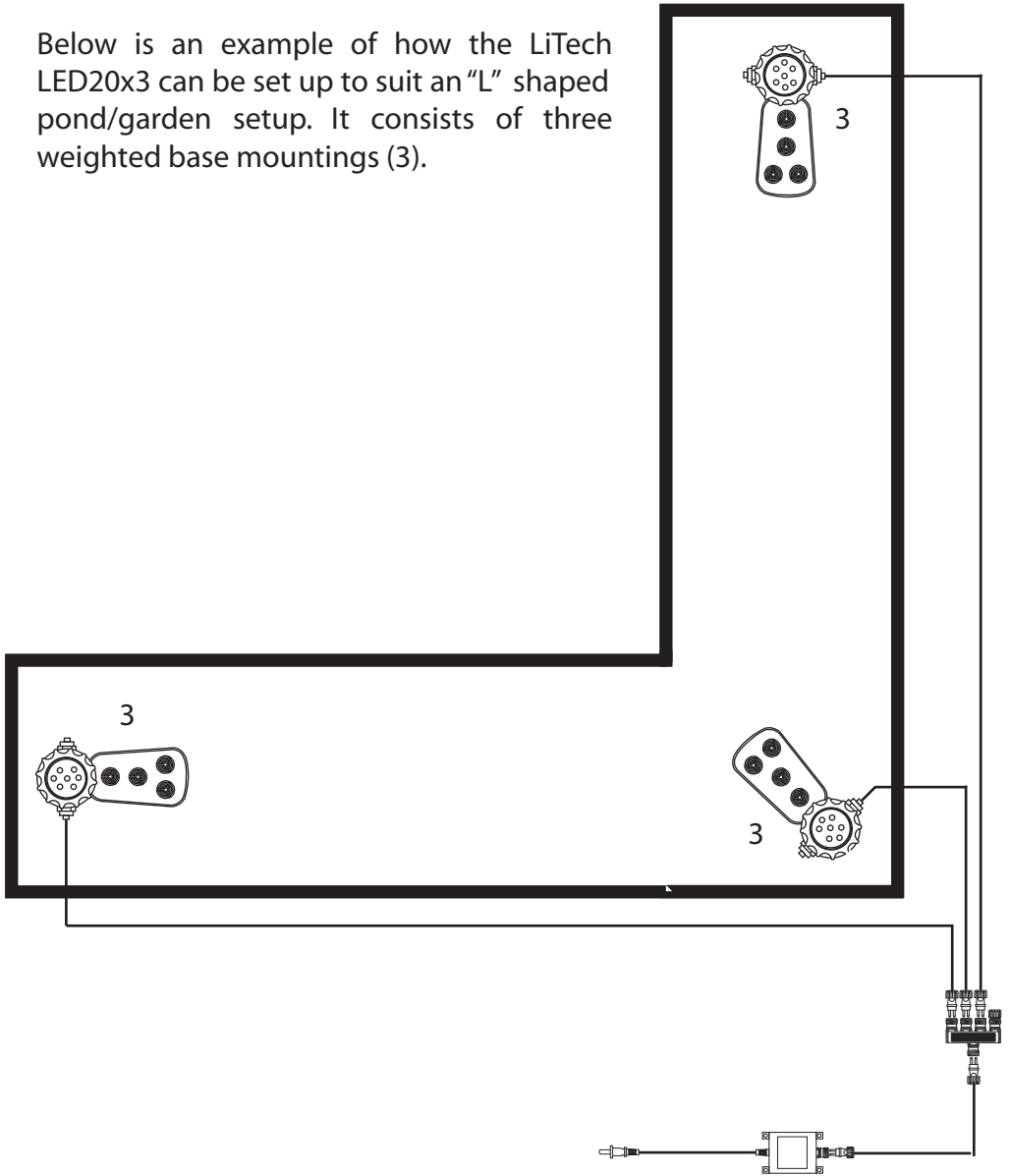

LiTech LED20x1 Set Up Option. Straight Configuration

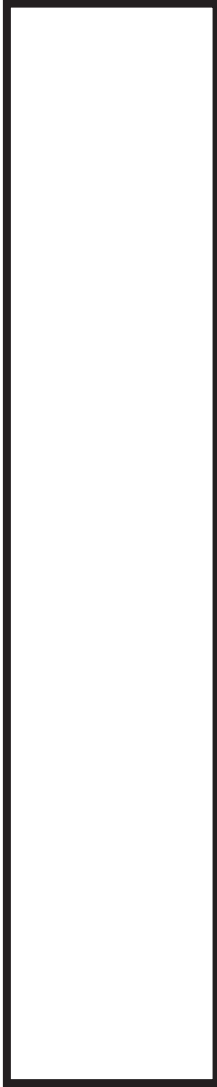

This is an example of how the LiTech LED20x1 can be set up to suit a straight pond/garden or path setup. It consists of one ground pick mounted light unit (2).

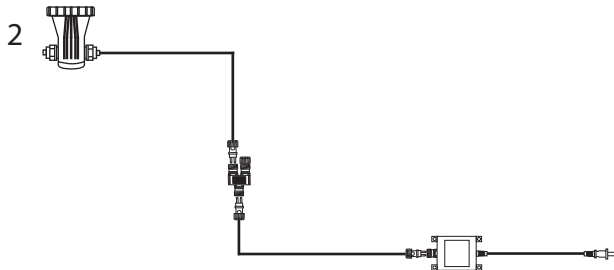

YOU MUST DISCONNECT THE POWER SUPPLY BEFORE CARRYING OUT ANY MAINTENANCE WORK OR HANDLING THE LIGHT IN ANY WAY.

To maximise the life of your lights it is recommended to clean the light casing and the glass lens on a regular basis.

Prior to cleaning, disconnect the lights from the electrical power supply.

The casing of the light can be cleaned with a firm brush. Do not use any abrasives to clean the glass lens. **DO NOT USE DETERGENTS AS THE USE OF THESE WILL BE POTENTIALLY LETHAL TO POND INHABITANTS.**

Replacing a Globe

Refer to page 2 for parts identification.

1. Turn the Lights off at the main power supply.
2. Remove the light from the water or mounting.
3. Remove the screw on cover by turning it anti clock wise.
4. Carefully remove the glass lens and the O-ring.
5. To remove the Globe you may need something small flat and made out of plastic. Place it in between the edge of the globe and the light casing.
6. Moving around the globe, gently pry the globe out. **Be careful** as the edge of the globe is made out of glass and may chip away. We advise wearing a pair of safety glasses.
7. Replace the globe. Ensure it is inserted correctly.
8. Check the O-ring is in good order and apply a pond safe lubricant to ensure a good water seal.
9. Replace the glass lens followed by the screw on cover. Hand tight will do.
10. Prior to reinstalling the light plug it in and turn on to ensure it works.

WARNING: Disconnect electrical supply before commencing any work on the lights.

1. MY LIGHTS ARE NOT WORKING.

- a. Check that the main power supply is plugged into the wall and that the switch is in the on position.
- b. Check that all the pin connections are inserted correctly and the collars on the pin connections are tight.
- c. Check the transformer! Attach a single light unit to the transformer and turn on. If it does not work try another light. If the light unit still does not work take the transformer to your supplying retailer for further testing.

2. ONE OF MY LIGHTS DOES NOT WORK.

- a. Check that the pin connector is inserted into the expander cable junction correctly and that the collar is tight.
- b. The globe may need to be replaced. Refer to the section on this page " Replacing a Globe" for further instruction.

3. THERE IS WATER INSIDE MY LIGHT.

- a. Turn the power off. Disconnect the light unit from the expander cable junction and open the light unit. The O-ring may have perished or may require lubrication. Either replace the O-ring or lubricate the O-ring with a pond safe lubricant.

Notes

Pond One - Guarantee 2 + 1 Year

Congratulations on your purchase of a quality Pond One product. This product will last for many years under normal usage the guarantee commences from the day of purchase. You must provide proof of purchase when you submit your equipment for repair under guarantee.

The benefits given to the purchaser by the manufacturers guarantee are in addition to all other rights and remedies which the purchaser has in respect of the equipment under the legislation of the appropriate country of purchase.

Your 2 year guarantee can be extended by a further 1 year upon registration with the distributor. This can be done online at the address below or by completing the extended guarantee registration card and returning by post to the address of your country of purchase.

www.aquaone.com.au

General Guarantee Conditions:

1. All claims for guarantee service should be made to the place of purchase.
2. You must provide proof of purchase when you submit your equipment for repair under guarantee.
3. This guarantee extends only to defects occurring in materials or workmanship under normal use of the equipment when operated in accordance with the supplied instructions.
4. Replacement equipment is guaranteed for the remainder of the original manufacturer's guarantee period.

Guarantee does not cover:

- a. Cost of freight, postage or the cost of insurance.
 - b. Service costs arising from failure to correctly adjust the controls of the product or to clean the casing or the glass lens, failure to observe the manufacturer's instructions or inspections that reveal that the equipment is in normal working order.
 - c. Equipment failures caused by misuse, neglect, normal wear and tear, accidental breakage, repairs or modification by unauthorised persons, lightning strikes, mains voltage fluctuation, earthquakes, vermin infestation or liquid spillage.
 - d. Consumables, such as bulbs, lamps or globes.
 - e. Damages to power supply cables, however caused.
 - f. In no event will the manufacturer or distributor of that country be liable for any consequential or incidental damage including, but not limited to loss of livestock, property damage, damage to equipment, appliances or furnishings arising from the use of this product or from failure of this product.
 - g. Damaged incurred in transit resulting from inadequate packing.
5. It is recommended that all equipment subject to claim should be prepared for transportation in its original packaging or other suitable packaging which offers the same degree of protection.

